

# Bicycle Route Map

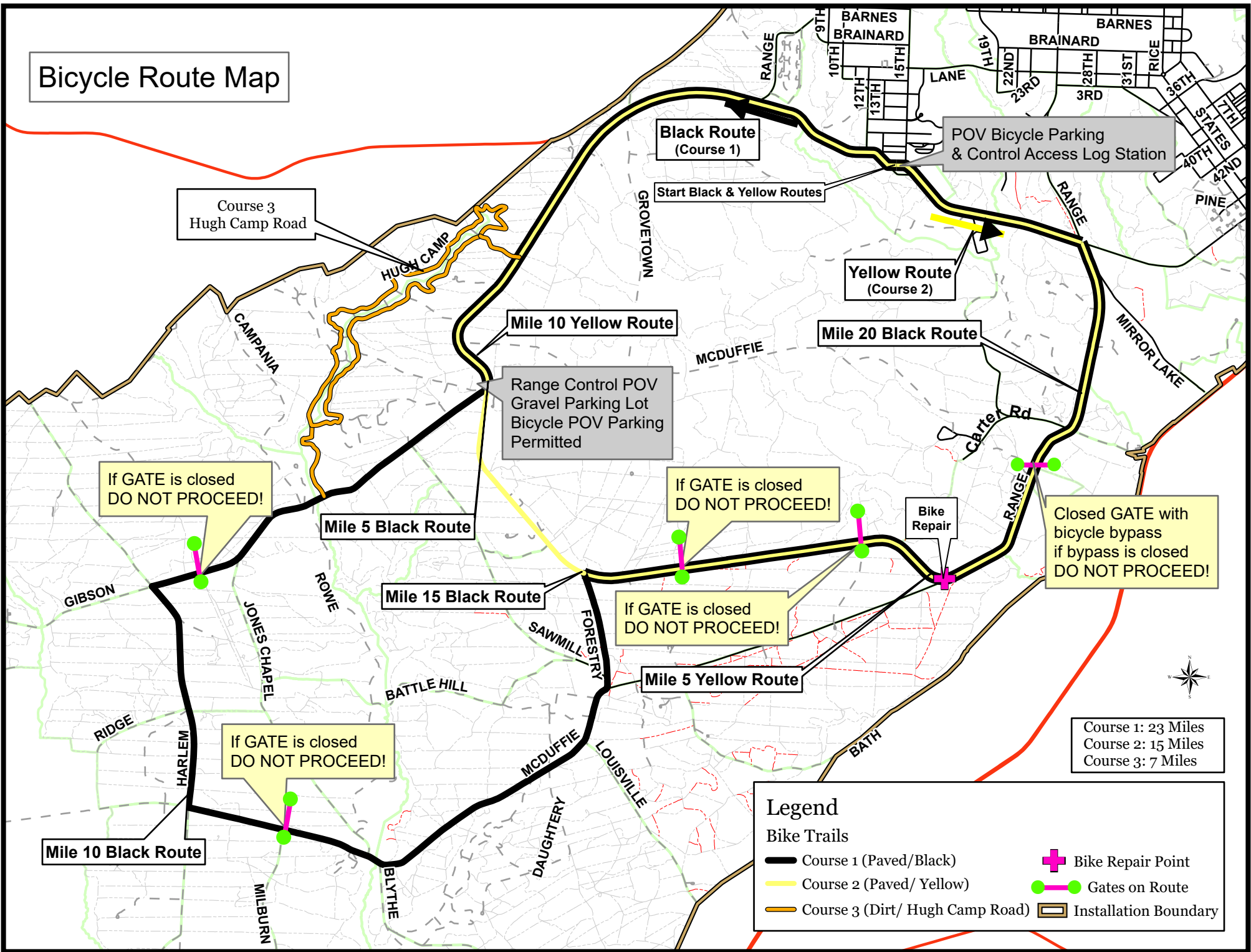

Course 1: 23 Miles  
 Course 2: 15 Miles  
 Course 3: 7 Miles

**Legend**

- Course 1 (Paved/Black)
- Course 2 (Paved/ Yellow)
- Course 3 (Dirt/ Hugh Camp Road)
- Bike Repair Point
- Gates on Route
- Installation Boundary